

## DF Series – Dryer Drives

DF Series are the new range of products, which are designed and developed after a detailed study of many equipments operating in real time. Our team of R&D engineers have defined the product after conducting several interviews and meetings with many OEMs and end-users to understand the needs and challenges in operating the equipment. The series is most suitable for mixers, dryers in various market segments like **Pharmaceutical Industry's Agitated Nutsche Filter Dryer (ANFD)**. The product has a **high power density which benefits in compact installations** and **the balanced center of gravity positioning leads to negligible noise and vibrations during operation**. The product also has the best-in-class radial load and axial load carrying capacities, which is the need of the hour for these applications.

### Features & Benefits:



#### Modular housings designed for high impact load carrying capacities

- 'Duo-Part housing' specially designed for easy and quick maintenance needs of the application
- Robust structural design provides dampening against vibrations



#### Reliable sealing system ensures protection against steam entry and dusty environment

- Long operating life and no oil losses
- Enhanced duration for maintenance



#### Robust bearing design and positioning for machine operational longevity

- High radial load and axial load carrying capacities while the machine is working
- Longer system life and protection against impact loads



#### Optimized gearing system with high power density and higher efficiencies

- High reliability against heavy operational loads applied on the system
- Compact system ensures lower installation space on the equipment

The New DF series is created with vast research and experience in specific applications across segments:

- Pharmaceutical Industry
- Agitated Nutsche Filter Dryer
- Intermediate Compounds and Fine Chemicals
- Organic Chemicals and Agro Chemicals
- Food Industry

#### Gear Ratios

100...180

#### Torque (Nm)

|       |        |
|-------|--------|
| DF80  | 7,700  |
| DF90  | 14,000 |
| DF100 | 26,100 |

#### Axial Load Capacity (N)

|       |         |
|-------|---------|
| DF80  | 90,000  |
| DF90  | 110,000 |
| DF100 | 135,000 |

#### Radial Load Capacity (N)

|       |         |
|-------|---------|
| DF80  | 90,000  |
| DF90  | 105,000 |
| DF100 | 125,000 |

Special features that allow flexibility and versatile operation:

- High hollow shaft diameters provides safety against peak torques and ease of steam pipe setting up
- Ease of access for lubricating oil maintenance due to easy access of ports
- Composed Drive with optimum positioning of center of gravity ensures better dynamic balancing of the geared-motor aiding in reduction of vibration and lower noise generation during peak loads

Dimensions:

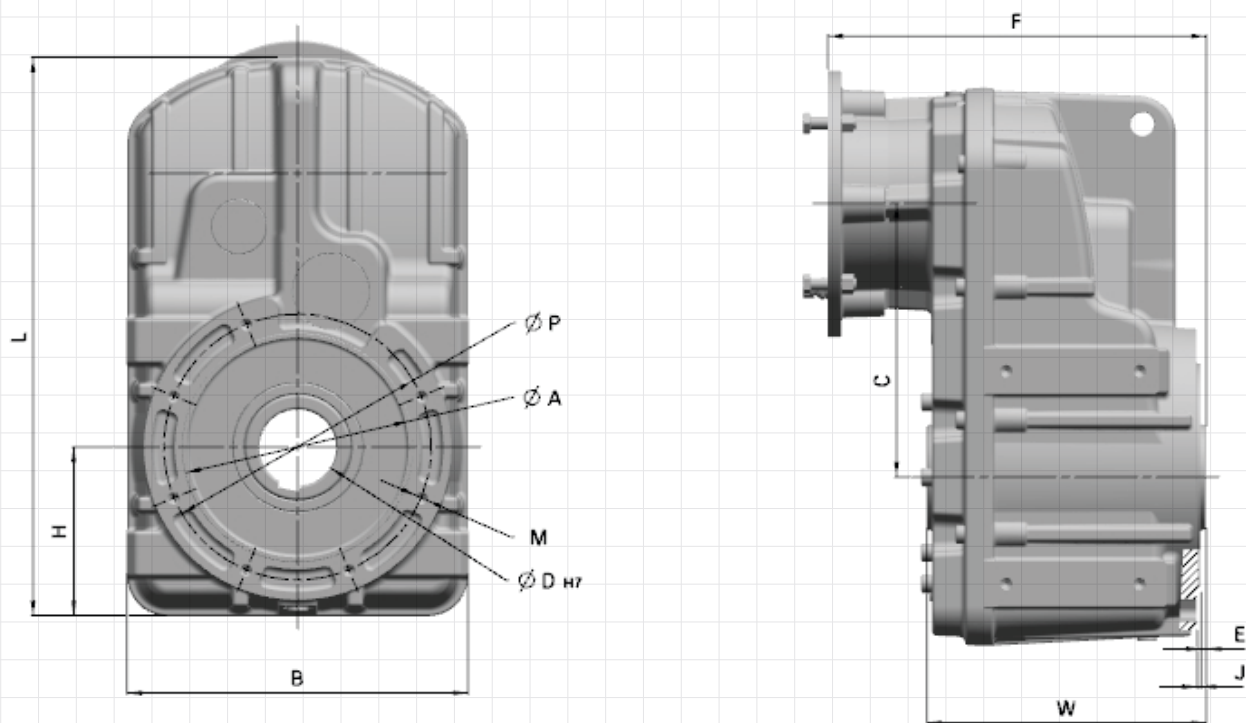

NOTE: For more details, installation drawing can be shared

| Model  | C     | L   | B   | W   | M   | F     | A   | M   | P   | D   | E  | J  |
|--------|-------|-----|-----|-----|-----|-------|-----|-----|-----|-----|----|----|
| DF 80  | 316.5 | 645 | 384 | 310 | 190 | 406.5 | 250 | M16 | 300 | 90  | 6  | 5  |
| DF 90  | 360   | 736 | 446 | 366 | 222 | 495.5 | 300 | M16 | 350 | 100 | 7  | 5  |
| DF 100 | 460   | 935 | 613 | 430 | 295 | 516   | 350 | M20 | 400 | 120 | 10 | 14 |